

# 1.10

## POLYURETHANE/PIR INSULATED FACADE PANEL

Composite facade panel with polyurethane/PIR insulation core.  
Provides thermal insulation.



Technical Specifications	SPD 1000
Useful Width (mm)	1000
Sheet Type and Thickness (mm)	Painted Galvanized Sheet (0,40 - 0,50 - 0,60 - 0,70 - 0,80)
Density	40 ( $\pm$ 2) kg/m <sup>3</sup>
Paint Type	Polyester PVdF
Colour	RAL 9002 <sup>a</sup>
Texture	Corrugated, Microlined
Insulation	Polyurethane/PIR
Insulation Thickness (mm) - h	40 - 50 - 60 - 75 - 80 - 100
Declared Thermal Conductivity (W/MK) <sup>c</sup>	$\leq$ 0,023
Reaction to Fire	NPD / B-s1, d0

<sup>a</sup>It is the standard colour. Other colours are produced on demand.

# 1.10

## PANEL DETAIL

www.tekiz.com.tr

### Hidden Screw

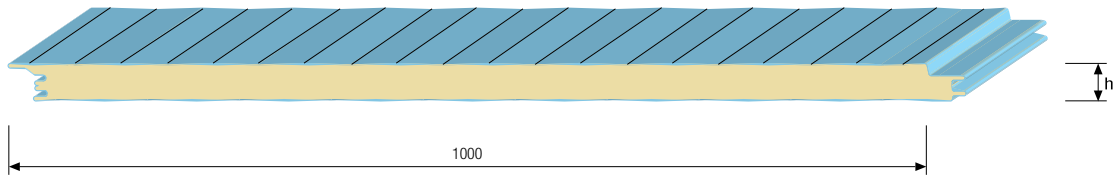

### Visible Screw

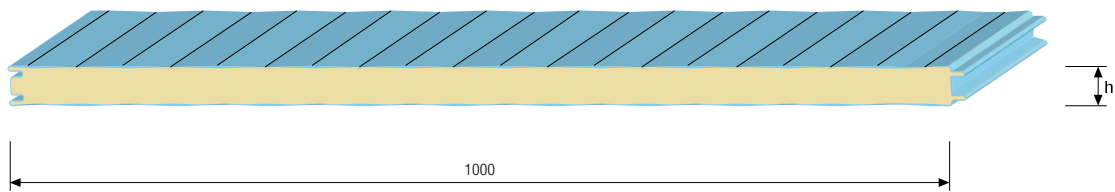

### Load Table

SPD 1000 POLYURETHANE/PIR INSULATED FACADE PANEL		Multi Support Span (L/200 L=m)						
Panel Thickness (mm)	Panel weights (kg/m <sup>2</sup> )	1,0	1,5	2,0	2,5	3,0	3,5	4,0
		Distributed Load Bearing (P=kg/m <sup>2</sup> )						
40	9,3	561	272	208	157	106	80	54
50	9,7	735	366	301	234	168	127	86
60	10,1	893	455	394	311	229	174	119
75	10,7	1197	590	472	375	279	224	169
80	10,9	1315	648	518	414	309	247	185
100	11,7	1557	778	643	516	390	321	251

Values on the table apply to the sheet thickness of 0,50 (top) + 0,50 (bottom)  
Insulated panel weights may vary depending on sheet thickness tolerances.

### Panel Joint Detail

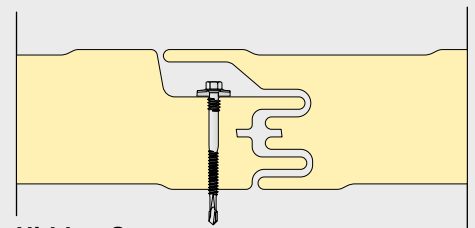

### Hidden Screw

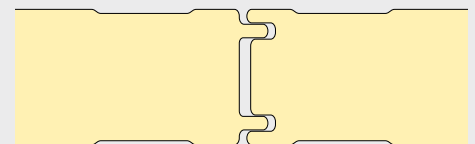

### Visible Screw